



**PHARMACOLD**  
PRECISION. PROTECTION. PERFORMANCE.

# MED-227

## MEDICAL REFRIGERATOR

2°C to 8°C | 8.0 Cu.Ft. | Glass Door

Purpose-built for the safe storage of pharmaceuticals, vaccines, and biological products. This unit is designed to deliver reliable temperature performance, enhanced security, and energy efficiency across a wide range of professional environments, including pharmacies, hospitals, clinics, laboratories, research facilities, medical offices, universities, veterinary practices, and life science settings.



### IDEAL FOR

- ✓ Vaccines
- ✓ Pharmaceuticals
- ✓ Biologics
- ✓ Clinical samples



### TEMPERATURE STABILITY

Maintains 2°C to 8°C with ±1°C uniformity



### AUDIBLE & VISUAL ALARMS

Alerts users to temperature deviations or door-open events



### SECURE & COMPLIANT

Key lock, alarm system & remote alert capabilities



### ENERGY EFFICIENT

Eco-friendly refrigerant and high-efficiency system



### DIGITAL CONTROLLER

Intuitive display with high/low temp alarms



### SECURITY LOCK

Keyed door lock for controlled access

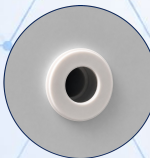

### PROBE ACCESS PORT

Supports external temperature probes for independent monitoring



### ADJUSTABLE SHELVES

Flexible storage to accommodate a variety of products



TEMPERATURE ALARM



DOOR AJAR ALARM



POWER FAILURE ALARM



REMOTE ALARM CONTACT



FORCED AIR COOLING



ECO REFRIGERANT



SECURITY LOCK



- Compassion
- Excellence
- Integrity
- Respect

## TRUSTED COLD STORAGE FOR LIFE-SAVING PRODUCTS

From vaccines and biologics to critical medications, every detail is designed to help maintain stability, reduce risk, and support dependable cold-chain management.



## KEY FEATURES

- ✓ 2°C to 8°C Operating Range
- ✓ ±1°C Temperature Uniformity
- ✓ Digital Temperature Controller
- ✓ High/Low Temperature Alarm
- ✓ Door Ajar Alarm
- ✓ Power Failure Alarm
- ✓ Remote Alarm Contact
- ✓ Adjustable Shelves
- ✓ LED Interior Lighting
- ✓ Key Lock
- ✓ Probe Access Port
- ✓ Eco-Friendly Refrigerant

## SPECIFICATIONS

### OVERVIEW

Capacity	227 Liters. (8.0 cu.ft.)
Door Style	Glass Door
Shelves	6.5 Shelves
Exterior Dimensions (W × D × H)	23.4" × 24.2" × 50.0"
Interior Dimensions (W × D × H)	20.0" × 17.0" × 41.3"
Net Weight	166 lbs

### TEMPERATURE PERFORMANCE

Temperature Range	2°C to 8°C
Temperature Uniformity	±1°C
Default Set Point	5°C
Controller	Digital LED

### ELECTRICAL

Voltage / Frequency	115V / 60Hz
Rated Current	1.4A
Plug Type	NEMA 5-15P

### ALARM FUNCTIONS

High / Low Temperature Alarm	Yes - Audible & Visual
Door Ajar Alarm	Yes
Power Failure Alarm	Yes
Remote Alarm Contact	Yes (Dry Contact)

### REFRIGERATION

Refrigerant	R600a, 49g
Defrost	Automatic
Cooling System	Forced Air

### ADDITIONAL FEATURES

Probe Hole	Yes
Castor / Feet	No / Yes - 4
Standard Hinge Side	Right
Reversible Door	Yes
Self Closing Door	Yes
Door Lock with Key	Yes

## DIMENSIONS

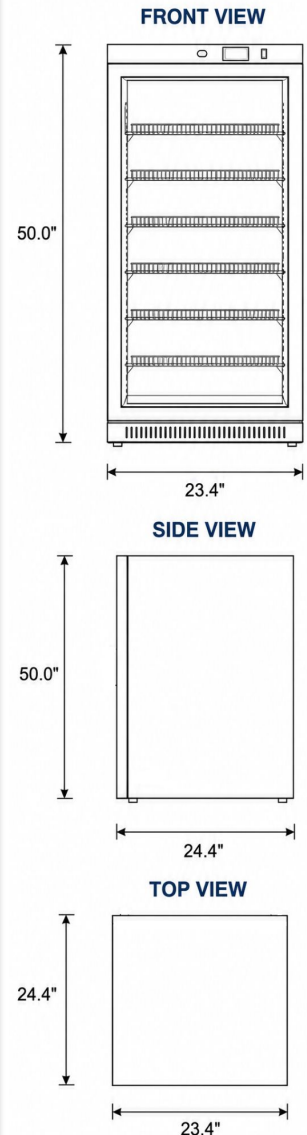

All dimensions are in inches (in).  
Drawings not to scale.

## CERTIFICATIONS



### DIGITAL CONTROLLER

Intuitive digital display for precise temperature control and easy monitoring.



### SECURITY LOCK

Keyed lock helps ensure products are stored safely and securely.



### ADJUSTABLE SHELVES

Customizable shelf positions to fit a wide range of storage needs.



### LED INTERIOR LIGHTING

Bright, even-energy LED lighting for clear visibility of stored items.

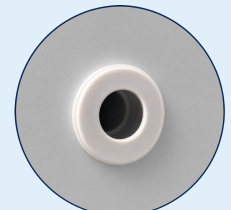

### PROBE ACCESS PORT

Easy access for additional temperature monitoring and validation.